

Varianten 2.1- 2.8
Seminar- und Tagungsraum (Bar)
Bestuhlungsvarianten
M 1:250

V2.1

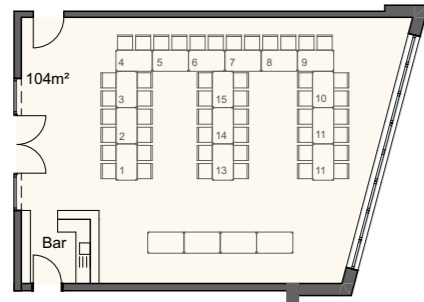

15 Tische (70x 120cm)
48 Sitzplätze

V2.2

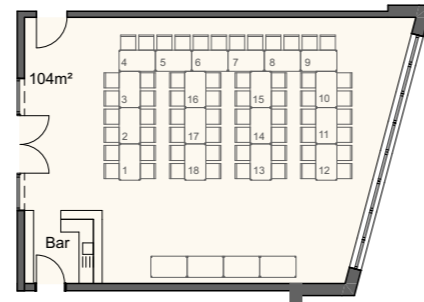

18 Tische (70x 120cm)
60 Sitzplätze

V2.3

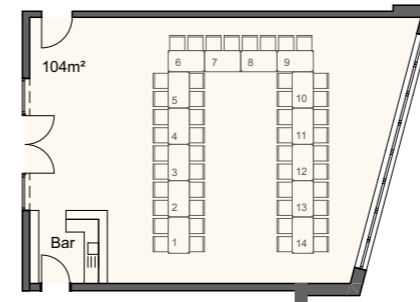

14 Tische (70x 120cm)
48 Sitzplätze

V2.4

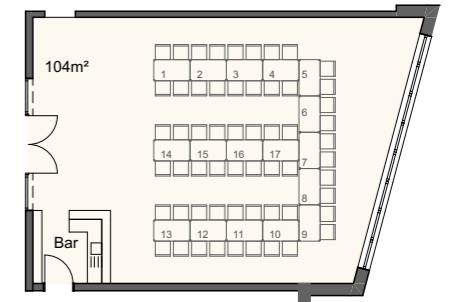

17 Tische (70x 120cm)
58 Sitzplätze

V2.5

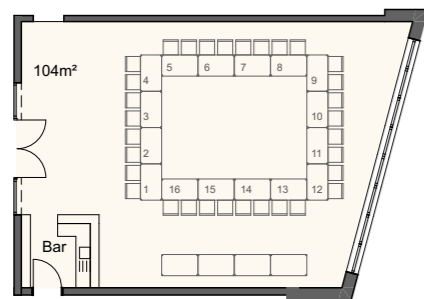

16 Tische (70x 120cm)
32 Sitzplätze

V2.6

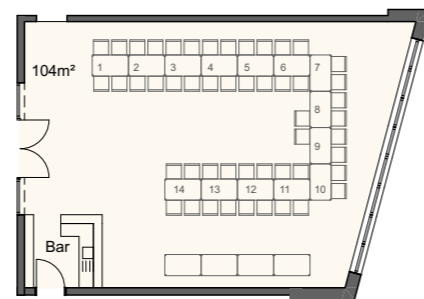

14 Tische (70x 120cm)
50 Sitzplätze

V2.7

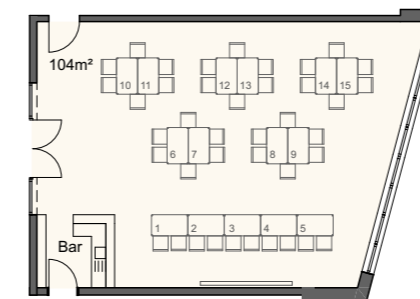

15 Tische (70x 120cm)
40 Sitzplätze

V2.8

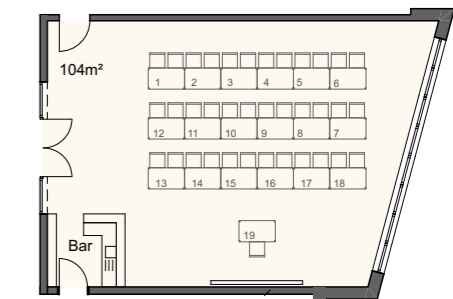

19 Tische (70x 120cm)
37 Sitzplätze